

STATE OF FLORIDA
DEPARTMENT OF TRANSPORTATION

CONTRACT PLANS

FINANCIAL PROJECT ID 442030-1-54-01

PALM BEACH COUNTY

BARFIELD HIGHWAY RECONSTRUCTION

SIGNING AND PAVEMENT MARKING PLANS

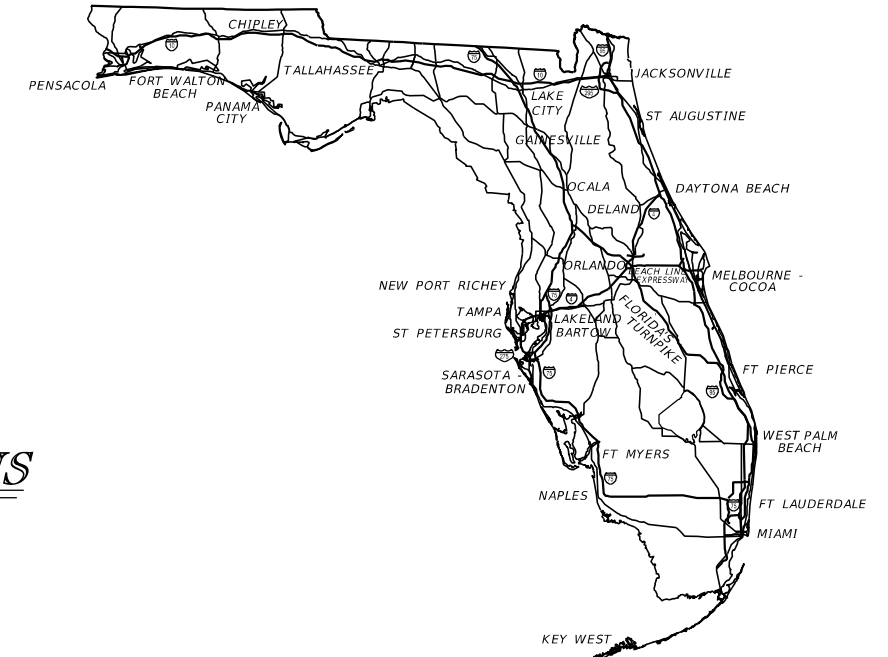

INDEX OF SIGNING AND PAVEMENT MARKING PLANS

SHEET NO.	SHEET DESCRIPTION
S-1	KEY SHEET
S-2	TABULATION OF QUANTITIES
S-3	GENERAL NOTES
S-4 - S-8	SIGNING AND PAVEMENT MARKING PLAN

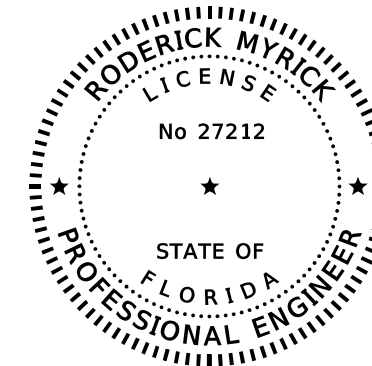

THIS ITEM HAS BEEN DIGITALLY SIGNED AND SEALED BY

ON THE DATE ADJACENT TO THE SEAL
PRINTED COPIES OF THIS DOCUMENT ARE NOT CONSIDERED SIGNED AND SEALED AND THE SIGNATURE MUST BE VERIFIED ON ANY ELECTRONIC COPIES.

**SIGNING AND PAVEMENT MARKING PLANS
ENGINEER OF RECORD:**

RODERICK MYRICK, P.E. NO.: 56969
AE ENGINEERING, INC.
219 N. NEWNAN ST., 4TH FLOOR
JACKSONVILLE, FL 32202
CERTIFICATE OF AUTHORIZATION: 27212

FDOT PROJECT MANAGER:
LEOS A. KENNEDY

FINAL SUBMITTAL
SEPTEMBER 2020

FISCAL YEAR	SHEET NO.
20	S-1

TABULATION OF QUANTITIES

PAY ITEM NO.	DESCRIPTION	UNIT	SHEET NUMBERS														TOTAL THIS SHEET		GRAND TOTAL	
			S-4		S-5		S-6		S-7		S-8		PLAN	FINAL	PLAN	FINAL	PLAN	FINAL		
			PLAN	FINAL	PLAN	FINAL	PLAN	FINAL	PLAN	FINAL	PLAN	FINAL	PLAN	FINAL	PLAN	FINAL	PLAN	FINAL		
0700 1 11	SINGLE POST SIGN, F&I GROUND MOUNT, UP TO 12 SF	AS	1		4		6		10		9						30	30		
0700 1 50	SINGLE POST SIGN, RELOCATE	AS	1					3									4	4		
0700 1 60	SINGLE POST SIGN, REMOVE	AS			2		5		4		5						16	16		
0705 10 1	OBJECT MARKER, TYPE 1	EA			6		3		3		3						15	15		
0710 90	PAINTED PAVEMENT MARKINGS, FINAL SURFACE	LS															1	1		
*	RETRO-REFLECTIVE PAVEMENT MARKERS (Y/Y)	EA	102		112		106		104		76						500	500		
*	PAINTED PAVEMENT MARKINGS, STANDARD., WHITE, SOLID, CROSSWALK/RA, 12"	LF			153.9		79.7		396.4		269.4						899.3	899		
*	PAINTED PAVEMENT MARKINGS, STANDARD, WHITE, SOLID, STOP LINES/CROSSWALK, 24"	LF	14.1		25.9		10.7		110.0		71.2						231.8	232		
*	PAINTED PAVEMENT MARKINGS, STANDARD, YELLOW, SOLID, 6"	GM	0.376		0.371		0.396		0.369		0.156						1.667	1.667		
0711 11123	THERMOPLASTIC, STANDARD, WHITE, SOLID, 12" FOR CROSSWALK AND ROUNDABOUT	LF			153.9		79.7		396.4		269.4						899.3	899		
0711 11125	THERMOPLASTIC, STANDARD, WHITE, SOLID, 24" FOR STOP LINE AND CROSSWALK	LF	14.1		25.9		10.7		110.0		71.2						231.8	232		
0711 14125	THERMOPLASTIC, PREFORMED, WHITE, SOLID, 24" FOR CROSSWALK	LF							174.5		120.0						294.5	294		
0711 16201	THERMOPLASTIC, STANDARD, OTHER SURFACES, YELLOW, SOLID, 6"	GM	0.376		0.371		0.396		0.369		0.156						1.667	1.667		

* THESE QUANTITIES ARE PAID FOR UNDER PAINTED PAVEMENT MARKINGS (FINAL SURFACE), LUMP SUM - ITEM NO. 710-90. THE QUANTITIES SHOWN ARE FOR ONE APPLICATION; SEE SPECIFICATION 710 FOR THE NUMBER OF APPLICATIONS REQUIRED.

<table border="1"> <thead> <tr> <th colspan="4">REVISIONS</th> </tr> <tr> <th>DATE</th> <th>DESCRIPTION</th> <th>DATE</th> <th>DESCRIPTION</th> </tr> </thead> <tbody> <tr> <td> </td> <td> </td> <td> </td> <td> </td> </tr> </tbody> </table>				REVISIONS				DATE	DESCRIPTION	DATE	DESCRIPTION					RODERICK MYRICK, P.E. P.E. LICENSE NUMBER 56969 AE ENGINEERING, INC. 219 N. NEWNAN STREET, 4TH FLOOR JACKSONVILLE, FL - 32202 CERTIFICATE OF AUTHORIZATION: 27212		CITY OF PAHOKEE ROAD NO. COUNTY FINANCIAL PROJECT ID PALM BEACH 442030-1-54-01			SHEET NO. S-2	
REVISIONS																						
DATE	DESCRIPTION	DATE	DESCRIPTION																			

TABULATION OF QUANTITIES

THE OFFICIAL RECORD OF THIS SHEET IS THE ELECTRONIC FILE DIGITALLY SIGNED AND SEALED UNDER RULE 61G15-23.004, F.A.C.

GENERAL NOTES:

1. SIGNING AND PAVEMENT MARKING TO BE DONE IN ACCORDANCE WITH THE MANUAL ON UNIFORM TRAFFIC CONTROL DEVICES FOR STREETS AND HIGHWAYS, 2009 LATEST EDITION.
2. PAVEMENT MARKINGS SHOULD BE PLACED AS SHOWN ON THE PLANS AND DETAIL SHEETS.
3. ANY REQUIRED TEMPORARY MARKINGS MUST BE IN PLACE BEFORE OPENING LANES OF TRAFFIC.
4. ALL PERMANENT PAVEMENT MARKINGS SHALL BE EXTRUDED THERMOPLASTIC AND MEET CURRENT FDOT STANDARD SPECIFICATIONS, LATEST EDITION.
5. THERMOPLASTIC PAVEMENT MARKINGS ARE TO BE PLACED NO SOONER THAN 30 CALENDAR DAYS AFTER THE COMPLETION OF THE FINAL PAVEMENT LAYER.
6. A BITUMINOUS REFLECTIVE PAVEMENT MARKER (RPM) ADHESIVE MEETING FDOT SPECIFICATIONS SHALL BE USED ON ASPHALT ROADWAYS.
7. ALL EXISTING SIGNS WITHIN THE PROJECT LIMITS ARE TO BE REMOVED UNLESS OTHERWISE NOTED ON THE PLANS.
8. THE REMOVAL OF EXISTING PAVEMENT MARKINGS WILL BE CONSIDERED AN INCIDENTAL ITEM WITH NO ADDITIONAL COMPENSATION PROVIDED.
9. PAVEMENT MARKINGS REMOVAL:
 - (A) PAINT BLACKOUT METHOD OF PAVEMENT MARKINGS REMOVAL IS NOT ACCEPTABLE.
 - (B) GRINDING OR HYDRO BLAST METHODS SHALL BE USED ON WEATHERED ASPHALT SURFACES.
 - (C) REMOVAL ON NEW ASPHALT SURFACES SHALL BE BY HYDRO BLAST METHOD ONLY.

REVISIONS				RODERICK MYRICK, P.E. P.E. LICENSE NUMBER 56969 AE ENGINEERING, INC. 219 N. NEWNAN STREET, 4TH FLOOR JACKSONVILLE, FL - 32202 CERTIFICATE OF AUTHORIZATION: 27212	CITY OF PAHOKEE			GENERAL NOTES	SHEET NO.
DATE	DESCRIPTION	DATE	DESCRIPTION		ROAD NO.	COUNTY	FINANCIAL PROJECT ID		S-3
					PALM BEACH	442030-1-54-01			

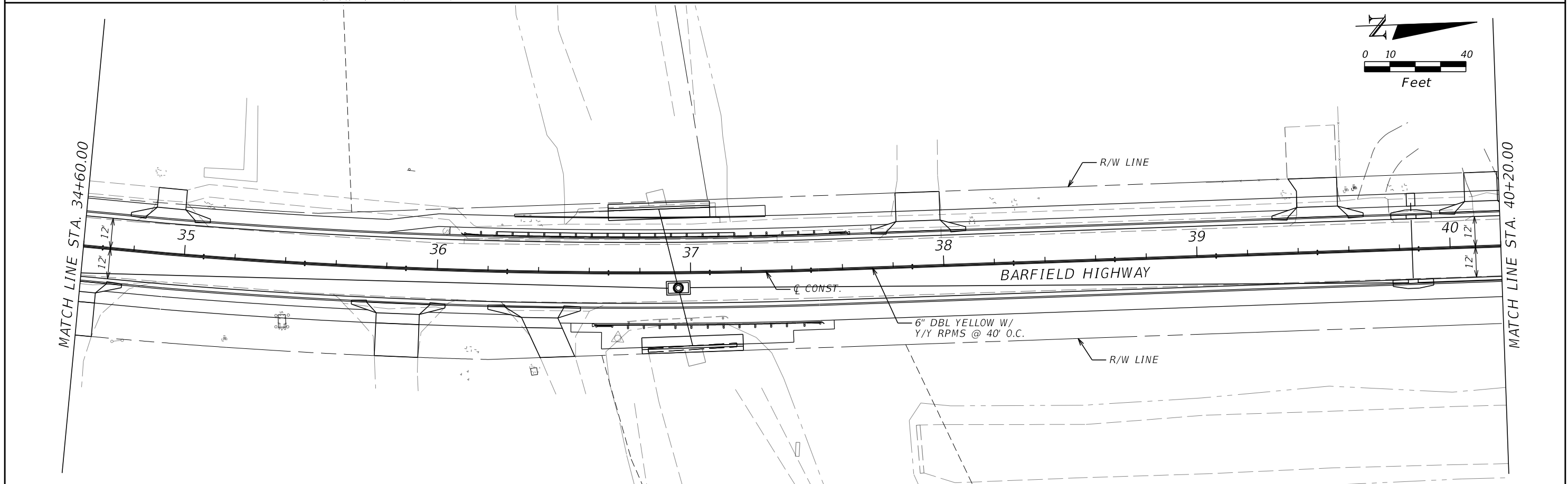
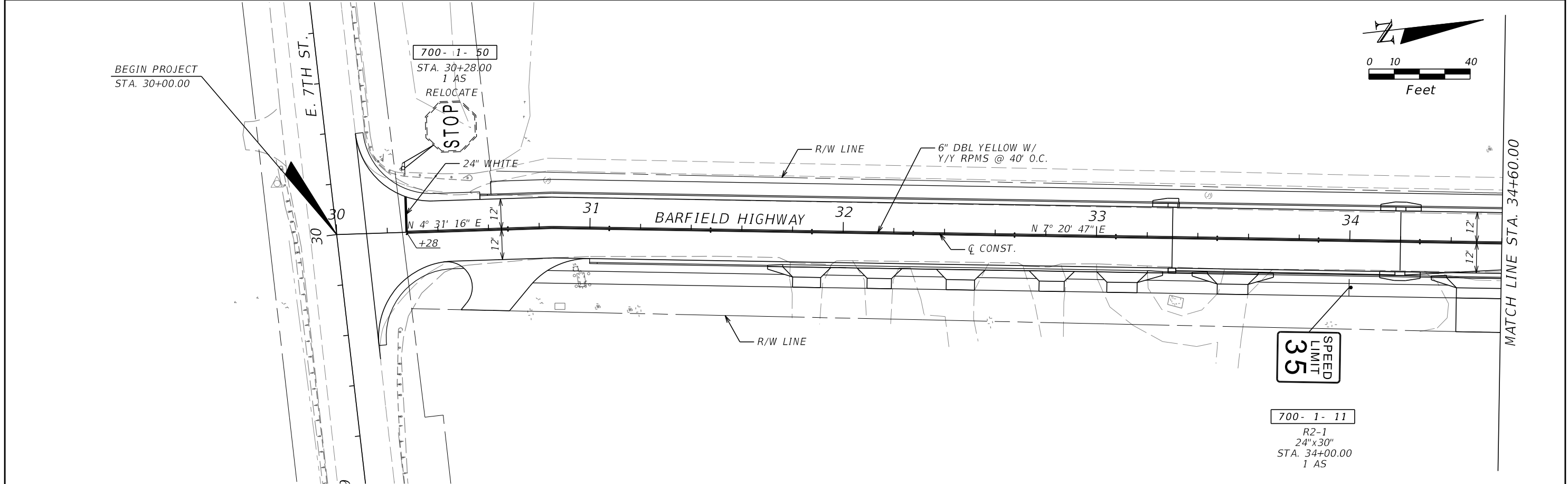

REVISIONS				RODERICK MYRICK, P.E. P.E. LICENSE NUMBER 56969 AE ENGINEERING, INC. 219 N. NEWNAN STREET, 4TH FLOOR JACKSONVILLE, FL - 32202 CERTIFICATE OF AUTHORIZATION: 27212	CITY OF PAHOKEE			SIGNING AND PAVEMENT MARKING PLAN	SHEET NO. S-4
DATE	DESCRIPTION	DATE	DESCRIPTION		ROAD NO.	COUNTY	FINANCIAL PROJECT ID		
					PALM BEACH	442030-1-54-01			

THE OFFICIAL RECORD OF THIS SHEET IS THE ELECTRONIC FILE DIGITALLY SIGNED AND SEALED UNDER RULE 61G15-23.004, F.A.C.

MATCH LINE STA. 40+20.00

MATCH LINE STA. 45+80.00

700- 1- 60
STA. 43+34.00
1 AS

700- 1- 11
R1-1
30"x30"
STA. 43+32.00
1 AS

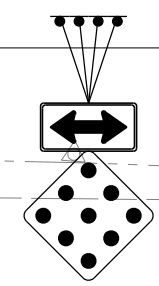
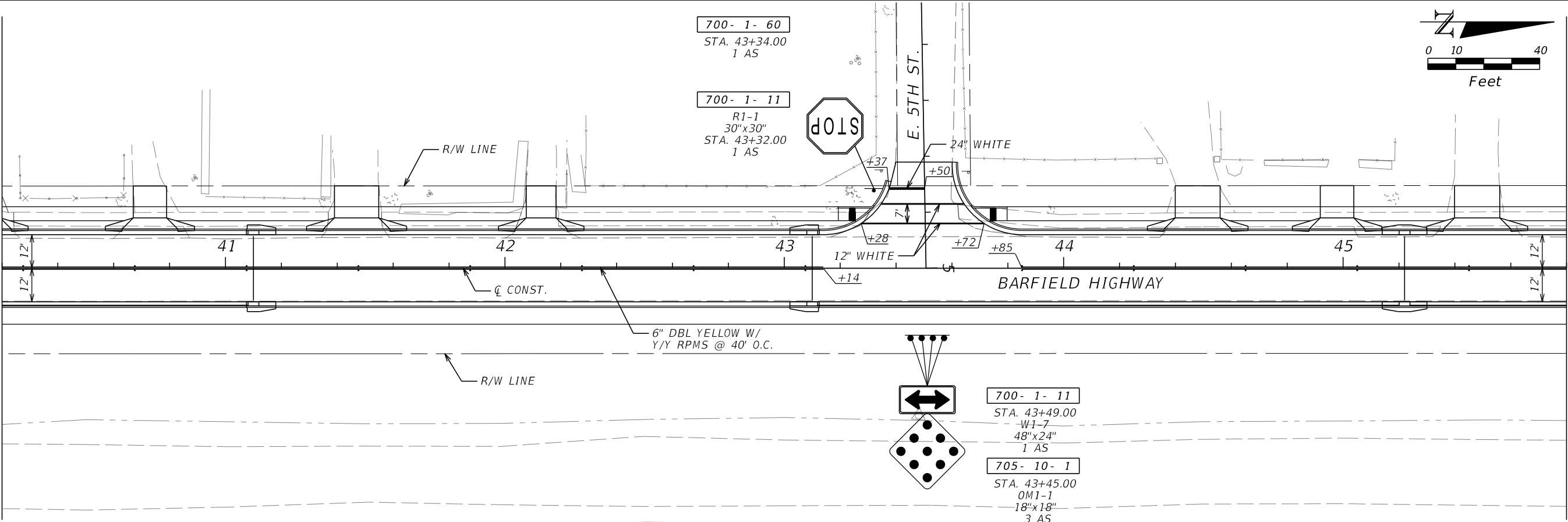
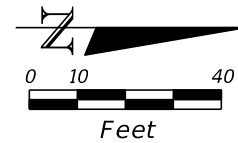

700- 1- 11
STA. 43+49.00
W1-7
48"x24"
1 AS

705- 10- 1
STA. 43+45.00
OM1-1
18"x18"
3 AS

MATCH LINE STA. 45+80.00

MATCH LINE STA. 51+40.00

700- 1- 60
STA. 50+03.00
1 AS

700- 1- 11
R1-1
30"x30"
STA. 49+95.00
1 AS

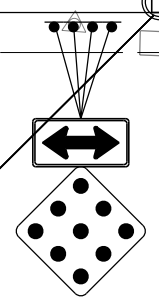
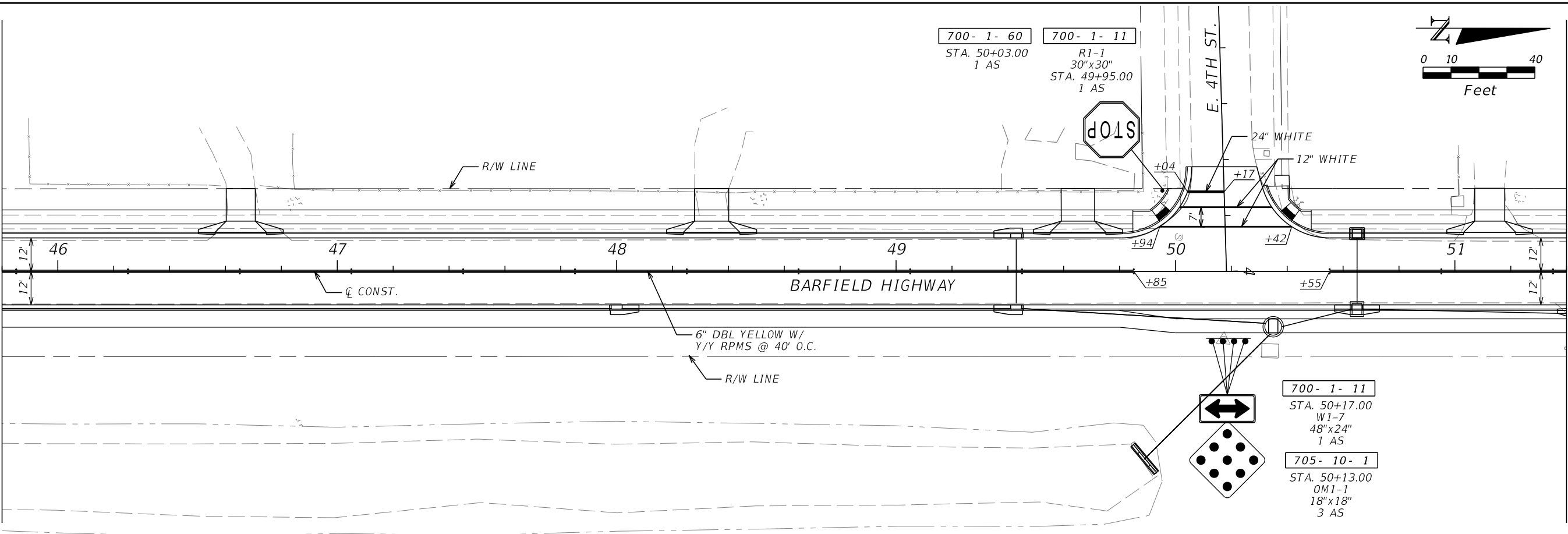
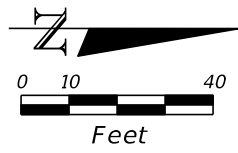

700- 1- 11
STA. 50+17.00
W1-7
48"x24"
1 AS

705- 10- 1
STA. 50+13.00
OM1-1
18"x18"
3 AS

REVISIONS			
DATE	DESCRIPTION	DATE	DESCRIPTION

RODERICK MYRICK, P.E.
P.E. LICENSE NUMBER 56969
AE ENGINEERING, INC.
219 N. NEWNAN STREET, 4TH FLOOR
JACKSONVILLE, FL - 32202
CERTIFICATE OF AUTHORIZATION: 27212

CITY OF PAHOKEE		
ROAD NO.	COUNTY	FINANCIAL PROJECT ID
	PALM BEACH	442030-1-54-01

**SIGNING AND PAVEMENT
MARKING PLAN**

SHEET NO.
S-5

MATCH LINE STA. 51+40.00

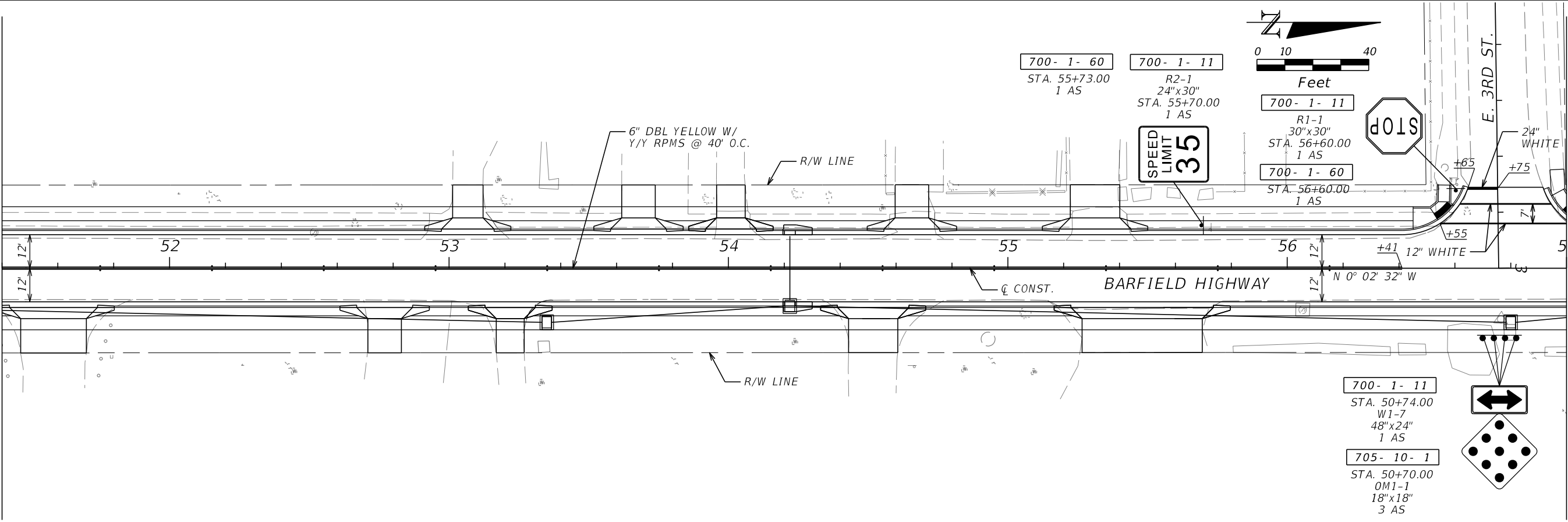

MATCH LINE STA. 57+00.00

MATCH LINE STA. 57+00.00

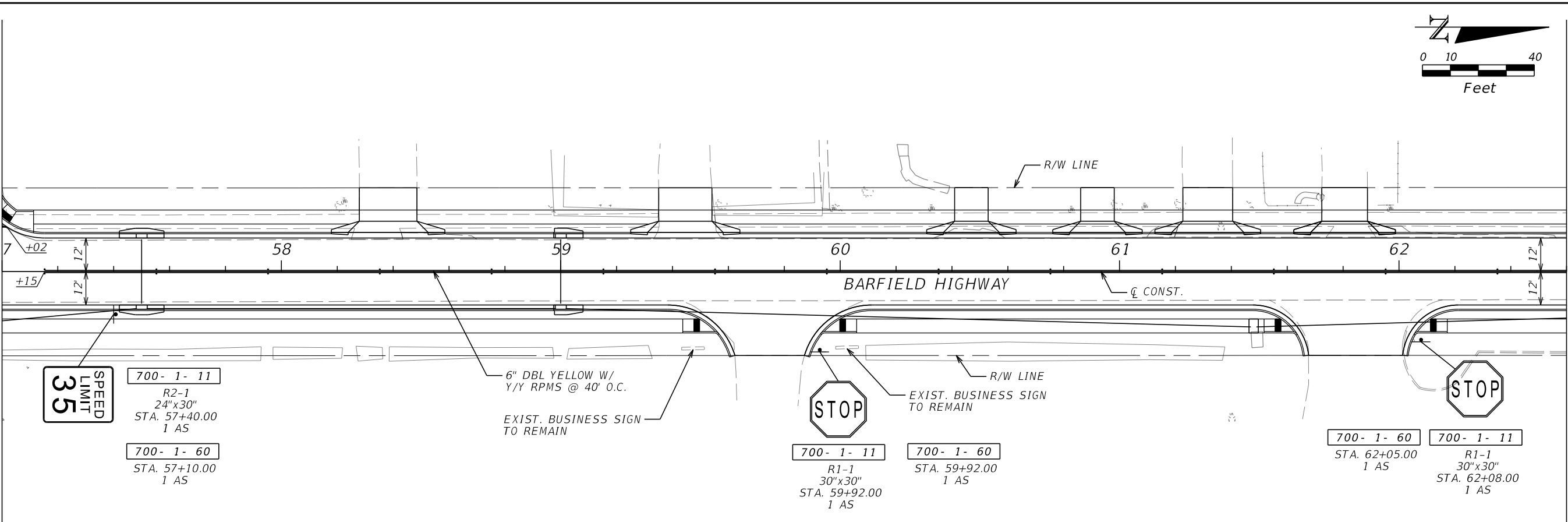

MATCH LINE STA. 62+60.00

REVISIONS			
DATE	DESCRIPTION	DATE	DESCRIPTION

RODERICK MYRICK, P.E.
 P.E. LICENSE NUMBER 56969
 AE ENGINEERING, INC.
 219 N. NEWNAN STREET, 4TH FLOOR
 JACKSONVILLE, FL - 32202
 CERTIFICATE OF AUTHORIZATION: 27212

CITY OF PAHOKEE		
ROAD NO.	COUNTY	FINANCIAL PROJECT ID
	PALM BEACH	442030-1-54-01

SIGNING AND PAVEMENT MARKING PLAN

SHEET NO.
S-6

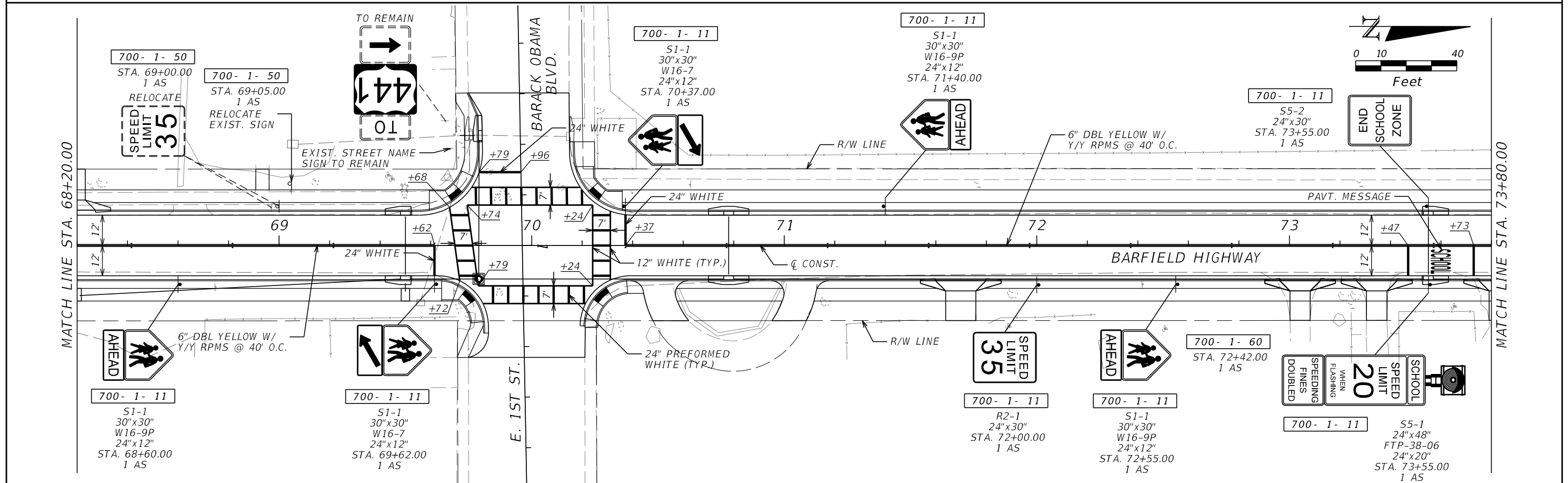
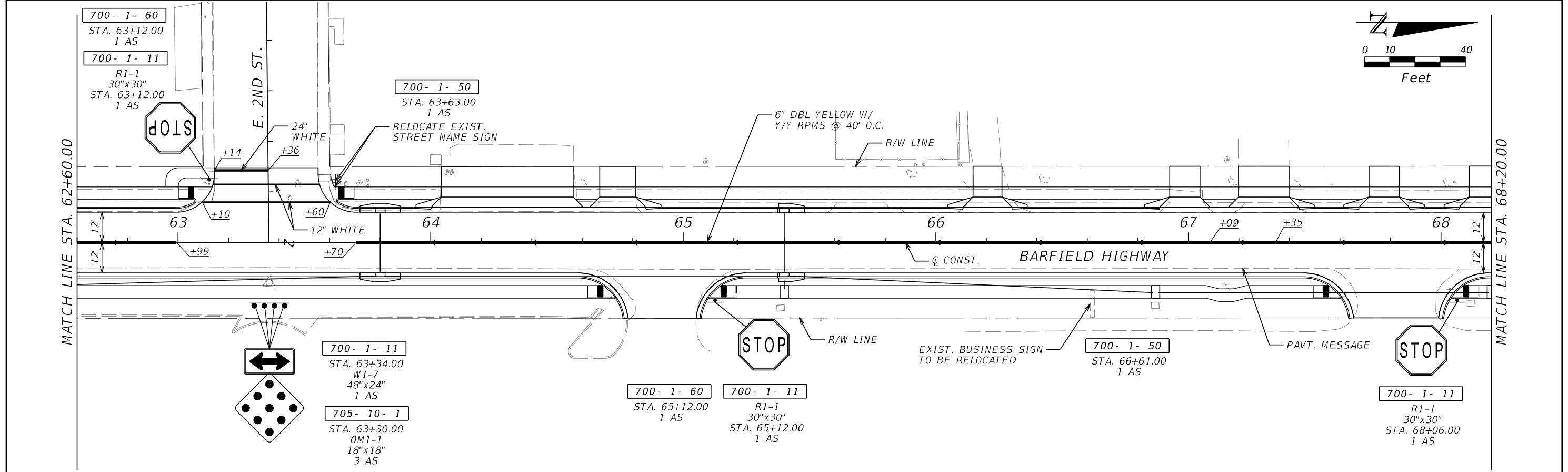

REVISIONS			
DATE	DESCRIPTION	DATE	DESCRIPTION

RODERICK MYRICK, P.E.
 P.E. LICENSE NUMBER 56969
 AE ENGINEERING, INC.
 219 N. NEWNAN STREET, 4TH FLOOR
 JACKSONVILLE, FL - 32202
 CERTIFICATE OF AUTHORIZATION: 27212

CITY OF PAHOKEE		
ROAD NO.	COUNTY	FINANCIAL PROJECT ID
	PALM BEACH	442030-1-54-01

SIGNING AND PAVEMENT MARKING PLAN

SHEET NO.
S-7

THE OFFICIAL RECORD OF THIS SHEET IS THE ELECTRONIC FILE DIGITALLY SIGNED AND SEALED UNDER RULE 61G15-23.004, F.A.C.

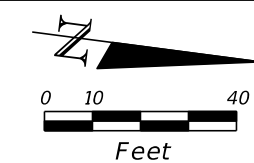
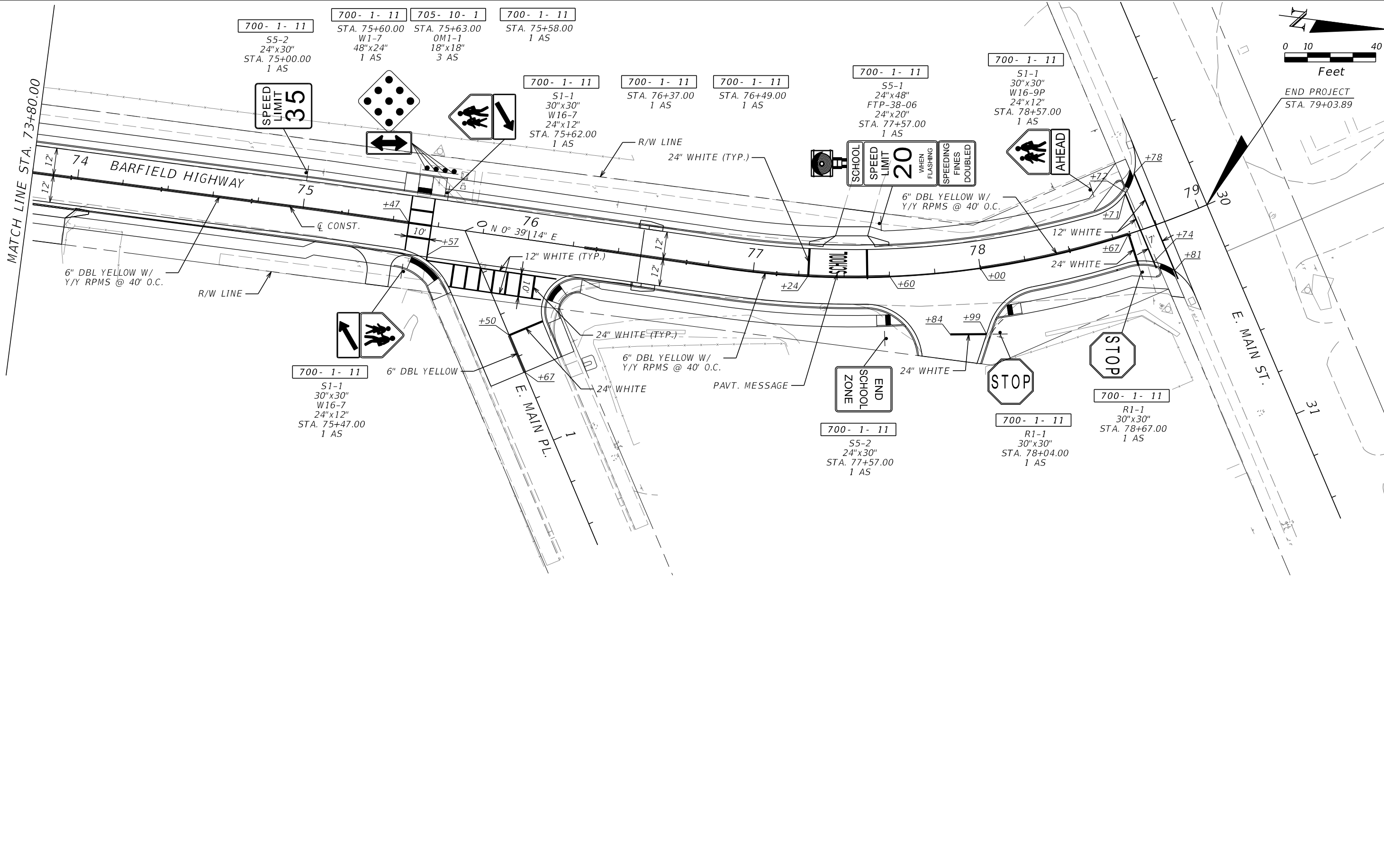

REVISIONS			
DATE	DESCRIPTION	DATE	DESCRIPTION

RODERICK MYRICK, P.E.
 P.E. LICENSE NUMBER 56969
 AE ENGINEERING, INC.
 219 N. NEWNAN STREET, 4TH FLOOR
 JACKSONVILLE, FL - 32202
 CERTIFICATE OF AUTHORIZATION: 27212

CITY OF PAHOKEE		
ROAD NO.	COUNTY	FINANCIAL PROJECT ID
	PALM BEACH	442030-1-54-01

**SIGNING AND PAVEMENT
MARKING PLAN**

SHEET NO.
S-8